

BIO

ZONE

IceZone® X- 05, 10, 20, 30
 Product Family: IceZone®
 Model: X-05, X-10, X-20, X-30
 Description: Sanitation System

POWER INFORMATION

Input Voltage: 100-240 V AC
 Input Frequency: 50/60 Hz
 Power Supply Output Voltage: 12 V DC
 Amperage: 0.800 A
 Electric Consumption: 9.6 W
 Power Supply Capacity: 2.08 A

SIZING INFORMATION

-specified by daily ice production-
 IZ-X-05: up to 600 lbs
 IZ-X-10: between 600 and 1200 lbs
 IZ-X-20: between 1200 and 1600 lbs
 IZ-X-30: >1600 lbs
 -high yeast environments may require a larger model

FEATURES

PlasmaPulse®
 PlasmaProtect®
 LED Status Indicators (optional)
 NSF Compliant Universal Installation Kit

APPLICATIONS

Ice Machines
 Ice Bins
 Beverage Dispensers
 Refrigerators
 Cold Storage
 Freezers
 Food Storage

MOUNTING OPTIONS

Top, side, back, internal, and wall-mount configurations available

WARRANTY

Warranty valid in United States and Canada.
 Contact factory for warranty in other countries.
 One year Parts and Labor on entire unit.

Product Certifications:



IceZone®-X Sanitation System



IZ-X-20
Shown



IZ-X-20
Shown installed on ice machines

- Prevent slime and mold
- Keep ice machines, ice bins, and beverage dispensers clean
- Reduce equipment cleanings and associated costs
- Reduce bacteria, yeast, and other microorganisms
- Decrease technical malfunctions and equipment downtime
- Completely automated and chemical-free
- Maintenance free – requires a simple annual UV lamp replacement

FSA-TECHNOLOGY INC.

Unit 2ARLI Bldg., South Point, Banay-banay
 Cabuyao City Laguna, Philippines 4025
 Tel #: +63 49 5446972 Email: fsasales@fsa-tech.com

IceZone® X- 05, 10, 20, 30
Product Family: IceZone®
Model: X-05, X-10, X-20, X-30
Description: Sanitation System

IceZone®

REORDER INFORMATION

Replacement UV Lamps

IZ-X-05: 10-08010

IZ-X-10: 10-08025

IZ-X-20: 10-08050

IZ-X-30: 10-08100

Replacement Power Supply

White (standard): 16-2000

Black (alternate): 16-2001

SPECIFICATIONS

Length: 12"
 Width: 4.25"
 Height: 2.2"
 Weight: 1.3 lbs

CONTENTS

- IceZone®
- Power Supply
- UV Lamp (pre-installed)
- Lock Key
- Owner's Manual and Installation Guide
- Installation Kit
 - includes NSF compliant:
 - tubing
 - fittings
 - clamps



IZ-X-20 Mounting Options

Shown installed on (L-R) side, internal, and wall-mount

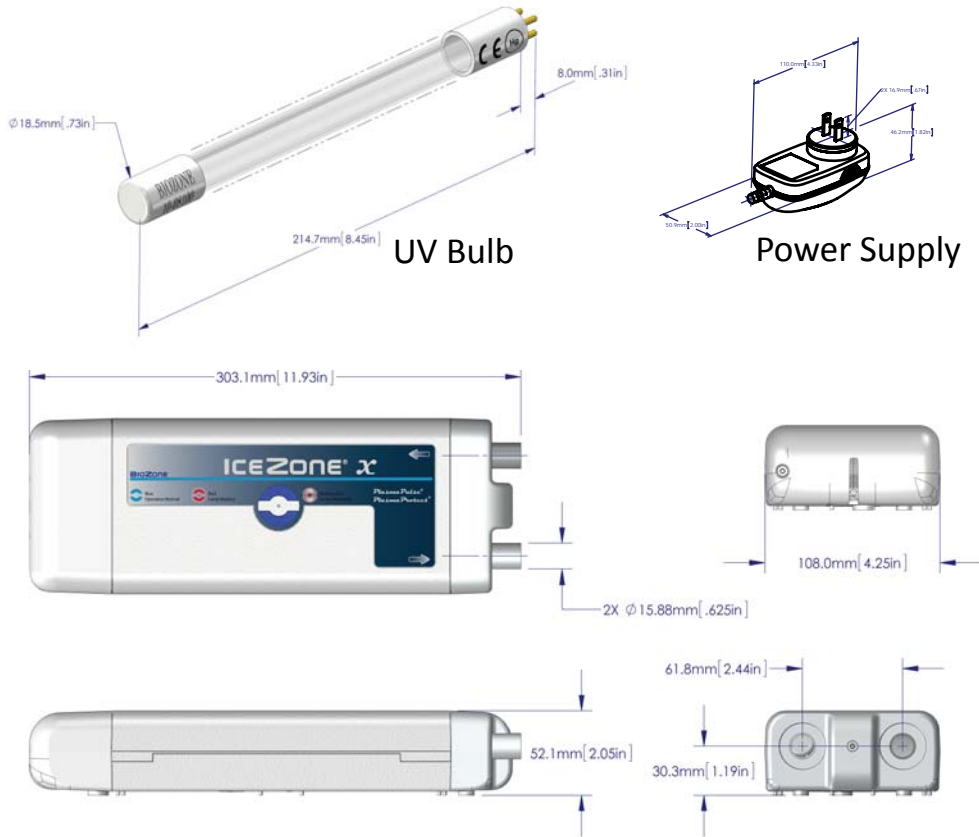

Compatible with all Major Ice Machine Manufacturers including:

- Follett
- Hoshizaki
- Ice-O-Matic
- Manitowoc
- Scotsman

(new and retrofit installations of ice machine and ice bins)

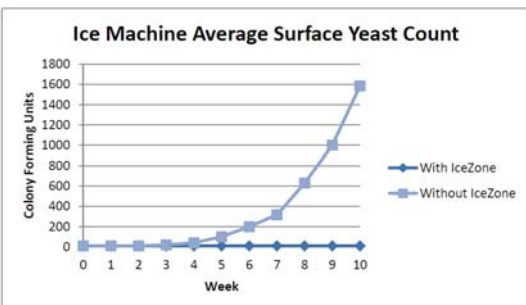
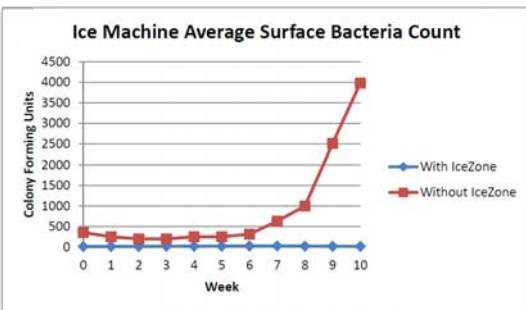

FSA-TECHNOLOGY INC.

Unit 2ARLI Bldg., South Point, Banay-banay
 Cabuyao City Laguna, Philippines 4025
 Tel #: +63 49 5446972 Email: fsasales@fsa-tech.com